

COMBI SYSTEM TYPE MCS

with stoker-inlet on the rear of the boiler

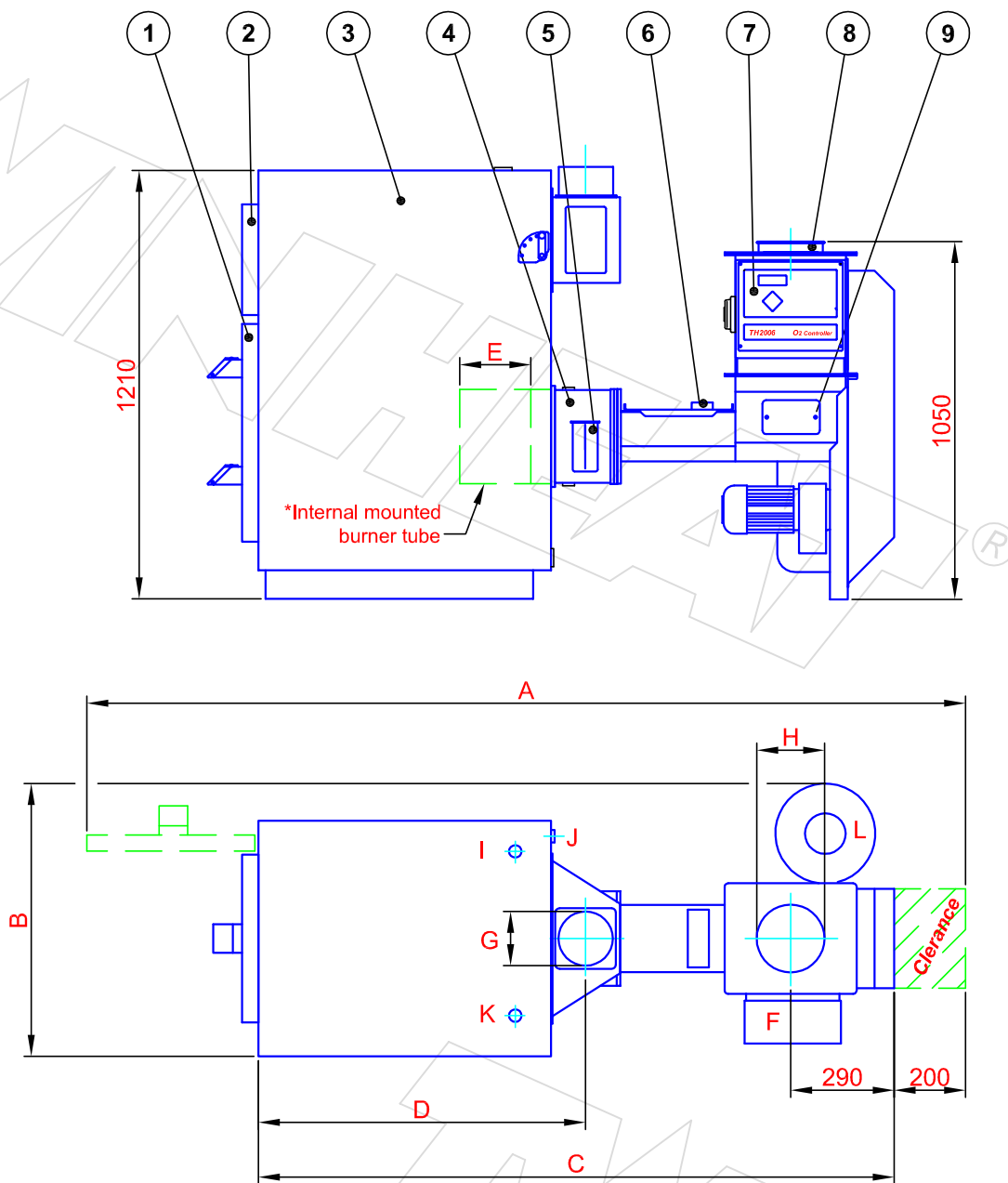

*The system is shown with "internal mounted burner tube" and therefore not suitable for heating with logs. If the system must be suitable for heating with logs, the measure "E" must be added to the measures A and C.

An internal mounted burner tube provides the advantage of a reduced length of the system. It is only an option by stoker-inlet on the rear of the boiler.

1. Boiler door
2. Cleaning door
3. Boiler unit
4. Burner tube
5. Fan
6. Sprinklersystem
7. Controller
8. Rotating valve
9. Stoker unit

Type	Dimensions					Connections						
	A	B	C	D	E	F Electrical con.	G Flue spigot	H Auger con.	I Flow	J Return	K Expansion	L Sprinkler
MCS20i	2690	770	1960	920	-		Ø153		G1"	G1"	G1"	
MCS40i	2960	770	2210	1330	440	Optional single phase 230V or 3 phase 400V	Ø185	Ø180	G1½"	G1½"	G1½"	G ½"
MCS80i	3630	960	2580	1350	340		Ø213		G2"	G2"	G2"	

Dimensions in mm.

Twin Heat A/S • Nørrevangen 7 • DK9631 Gedsted
 Mail: twinheat@twinheat.dk • www.twinheat.dk

With stoker-inlet on the side of the boiler

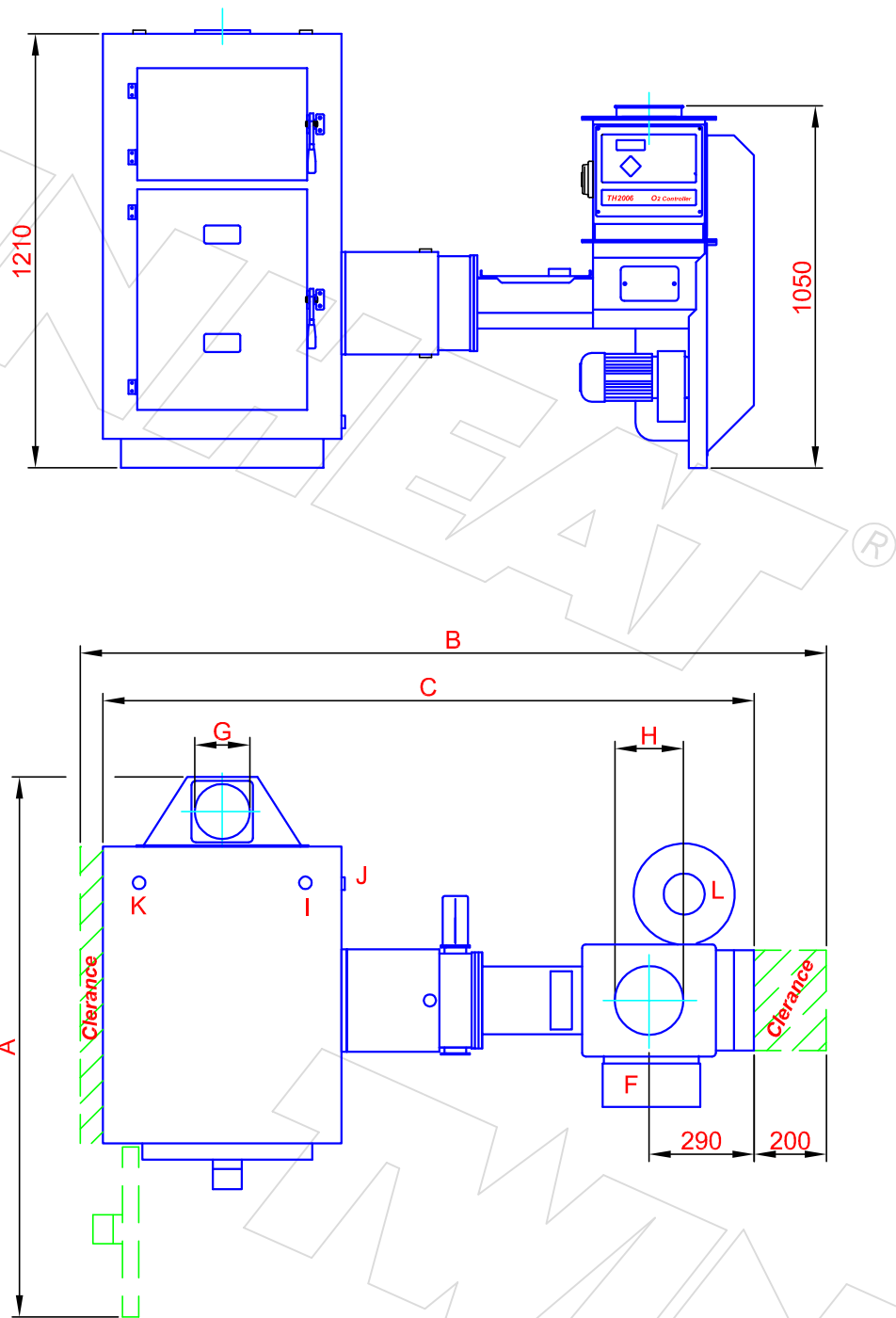

Type	Dimensions			Connections						
	A	B	C	F	G	H	I	J	K	L
MCS20i	1510	2060	1790	Electrical con.	Flue spigot		G1"	G1"	G1"	
MCS40i	1980	2325	2055	Optional single phase 230V or 3 phase 400V	Ø185	Ø180	G1½"	G1½"	G1½"	G ½"
MCS80i	2280	2970	2650		Ø213		G2"	G2"	G2"	

Dimensions In mm.