

Ball Transfer

Ball Transfer Tables

Ball transfer units are used where product must change direction or at an intersection of two conveyors. Table assemblies are designed to match-up with 1.9" diameter roller conveyor frames. For existing conveyors, the drop-in insert plate design allows for the removal of rollers and ball assembly insert plates to be "dropped-in" and bolted, applies to 1.9" & 1-3/8" roller conveyors. **Stands not included with ball table assemblies.**

Construction:

Ball assemblies: 1" diameter steel ball with a 1-3/4" diameter steel housing, 1/4-20 center post mount.

Frame: 3-1/2" x 1-3/8" x 11 ga. painted steel channel with butt plates.

Insert plates: 6" x 1" x 12 ga. galvanized channel; bolts into side frames; ball holes punched on 1" centers.

Widths: Standard BF's include 10", 16", 22" & 36".

Capacity: Maximum distributed live Load:

Frame 120 Lbs./Ft. on 10' support centers
600 Lbs./Ft. on 5' support centers (except 36" BF)
500 Lbs./Ft. on 5' support centers for 36" BF

Ball Assembly 75 Lbs. each

note: Welded construction tables available in different widths and lengths.

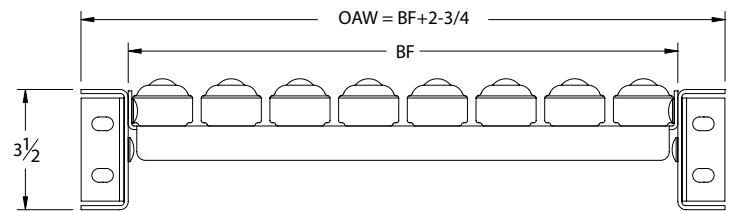

part number	BF	Ball Centers	Wt. (l bs./Ft.)
BTIT10__2	10"	2"	23
BTIT10__3	10"	3"	16
BTIT10__4	10"	4"	15
BTIT13__2	13"	2"	27
BTIT13__3	13"	3"	19
BTIT13__4	13"	4"	17
BTIT16__2	16"	2"	33
BTIT16__3	16"	3"	22
BTIT16__4	16"	4"	18
BTIT16__6	16"	6"	16
BTIT22__2	22"	2"	43
BTIT22__3	22"	3"	27
BTIT22__4	22"	4"	23
BTIT22__6	22"	6"	19
BTIT27__2	27"	2"	50
BTIT27__3	27"	3"	33
BTIT27__4	27"	4"	27
BTIT27__6	27"	6"	22
BTIT36__2	36"	2"	65
BTIT36__3	36"	3"	41
BTIT36__4	36"	4"	33
BTIT36__6	36"	6"	27

Replace "___" in Part Number with length in 6" increments up to 10' (1' = 010; 1'-6" = 015)

Table Capacity (evenly distributed load)
Pounds/Foot

Support Centers	10BF	13BF	16BF	22BF	27BF	36BF
10'	120	120	120	120	120	120
5'	600	600	600	500	350	250

For existing conveyors, the drop-in insert plate design allows for the removal of rollers and ball assembly insert plates to be "dropped-in" and bolted, applies to 1.9" & 1-3/8" roller conveyors.

Construction:

Ball assemblies: 1" diameter steel ball with a 1-3/4" diameter steel housing, 1/4-20 center post mount.

Insert plates: 6" x 1" x 12 ga. galvanized channel; bolts into side frames; ball holes punched on 1" centers.

Capacity: Ball assembly 75 Lbs. each

part number	BF	Ball Centers	Wt. (l bs.)
BTI102	10"	2"	8.4
BTI103	10"	3"	4.8
BTI104 1r o W	10"	4"	3.6
BTI104 2r o W	10"	4"	4.8

part number	BF	Ball Centers	Wt. (l bs.)
BTI132	13"	2"	10.2
BTI133	13"	3"	6.2
BTI134 1r o W	13"	4"	4.6
BTI134 2r o W	13"	4"	6.2

part number	BF	Ball Centers	Wt. (l bs.)
BTI162	16"	2"	13.3
BTI163	16"	3"	7.7
BTI164 1r o W	16"	4"	5.3
BTI164 2r o W	16"	4"	6.9
BTI166	16"	6"	4.9

part number	BF	Ball Centers	Wt. (l bs.)
BTI223	22"	2"	18.2
BTI223	22"	3"	10.6
BTI224 1r o W	22"	4"	7.4
BTI224 2r o W	22"	4"	9.8
BTI226	22"	6"	6.6

part number	BF	Ball Centers	Wt. (l bs.)
BTI273	27"	2"	20.6
BTI273	27"	3"	12.2
BTI274 1r o W	27"	4"	7.4
BTI274 2r o W	27"	4"	10.6
BTI276	27"	6"	7.0

part number	BF	Ball Centers	Wt. (l bs.)
BTI362	36"	2"	29.6
BTI363	36"	3"	17.6
BTI364 1r o W	36"	4"	11.6
BTI364 2r o W	36"	4"	15.2
BTI366	36"	6"	10.4

Insert Capacity (pounds - evenly distributed load)
(does not include ball capacity)

10BF	13BF	16BF	22BF	27BF	36BF
400	375	300	250	175	125

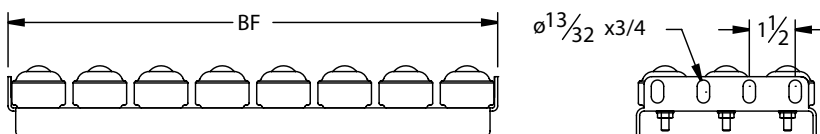
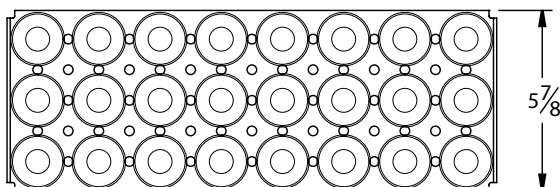

Ball Transfer

Ball Transfer units

Ball transfers allow for change of direction and rotation. Ideal for free movement of tools, dies, fixtures, containers, and assemblies. Use where smooth-surfaced items must change direction such as the intersection of two conveyors. Applications include conveyor system ball transfer tables, turntables, sorting tables, cargo decks, feed tables for metal working, die and fixture handling and storage and assembly lines. All ball transfers are sealed and lubricated for long life (except nylon ball). Carbon steel components are zinc plated.

Threaded Stud Style Ball Transfer units

Key	Ball Dia. (In.)	Ball Material	Housing Material	Cap. (Lbs.)	Stud Size	A (In.)	B (In.)	C (In.)	D (In.)	Wt. (Lbs.)	Part No.
A	5/8	Nylon	Carbon Stl	17	1/4-20x1/2	13/16	15/16	5/32	1-3/16	0.3	37809
A	5/8	Carbon Stl	Carbon Stl	33	1/4-20x1/2	13/16	15/16	5/32	1-3/16	0.3	25906
A	1	Nylon	Carbon Stl	100	5/16-18x3/4	1-1/4	1-3/8	9/32	1-43/64	0.5	37810
A	1	Carbon Stl	Carbon Stl	200	5/16-18x3/4	1-1/4	1-3/8	9/32	1-43/64	0.7	25907
B	1	Carbon Stl	Carbon Stl	150	3/8-16x11/16	1-1/2	2-7/16	2-3/16	5/32	.4	48774
B	1-1/8	Carbon Stl	Carbon Stl	200	3/8-16x11/16	1-19/32	2-7/16	2-3/16	5/32	.5	48772
B	1-1/4	Carbon Stl	Carbon Stl	250	3/8-16x11/16	1-3/4	2-7/16	2-3/16	5/32	.6	48773
C	1-1/2	Nylon	Carbon Stl	125	3/8-16x1	2-5/16	3-1/4	-	-	1.6	39049
C	1-1/2	Carbon Stl	Carbon Stl	250	3/8-16x1	2-5/16	3-1/4	-	-	1.6	37817
C	1-1/2	Stainless Stl	Carbon Stl	250	3/8-16x1	2-5/16	3-1/4	-	-	1.6	39051
D	1	Carbon Stl	Carbon Stl	150	1/4-20x13/32	1-7/16	1-1/4	-	-	.3	48775
D	1	Carbon Stl	Carbon Stl	150	5/16-18x11/16	1-7/16	1-1/4	-	-	.3	48776
E	1	Nylon	Carbon Stl	35	1/4-20x11/16	1-3/8	1-3/4	-	-	0.5	24256
E	1	Nylon	Stainless Stl	35	1/4-20x11/16	1-3/8	1-3/4	-	-	0.5	37811
E	1	Carbon Stl	Carbon Stl	75	1/4-20x11/16	1-3/8	1-3/4	-	-	0.6	14038
E	1	Stainless Stl	Stainless Stl	75	1/4-20x11/16	1-3/8	1-3/4	-	-	0.6	25904
E	1	Nylon	Carbon Stl	35	5/16-18x11/16	1-3/8	1-3/4	-	-	0.5	37813
E	1	Carbon Stl	Carbon Stl	75	5/16-18x11/16	1-3/8	1-3/4	-	-	0.6	37812
E	1	Stainless Stl	Carbon Stl	75	5/16-18x11/16	1-3/8	1-3/4	-	-	0.6	37815
E	1	Stainless Stl	Stainless Stl	75	5/16-18x11/16	1-3/8	1-3/4	-	-	0.6	37816

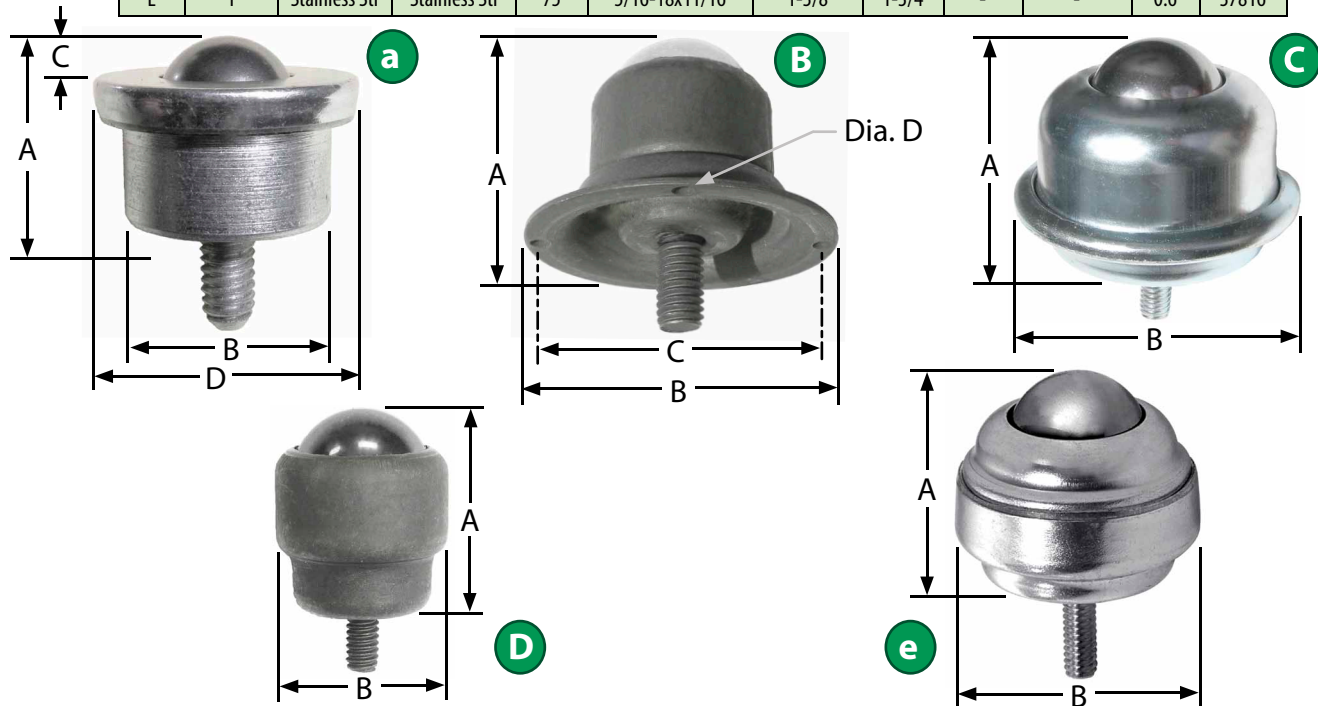

Ball Transfer

Flange Style Ball Transfer units

Key	Ball Dia. (In.)	Ball Material	Housing Material	Cap. (Lbs.)	Flange Size (In.)	Flange to Ball A (In.)	B (In.)	C (In.)	D (In.)	E (In.)	Wt. (Lbs.)	Part No.
F	1	Nylon	Carbon Stl	35	2x2-3/4	1-3/16	2-3/16	-	7/32	-	0.4	22279
F	1	Nylon	Stainless Stl	35	2x2-3/4	1-3/16	2-3/16	-	7/32	-	0.4	37820
F	1	Carbon Stl	Carbon Stl	75	2x2-3/4	1-3/16	2-3/16	-	7/32	-	0.5	14966
F	1	Stainless Stl	Carbon Stl	75	2x2-3/4	1-3/16	2-3/16	-	7/32	-	0.5	37819
F	1	Stainless Stl	Stainless Stl	75	2x2-3/4	1-3/16	2-3/16	-	7/32	-	0.5	25905
G	11/16	Carbon Stl	Carbon Stl	90	2-7/16x1-11/16	1	2	-	5/32	-	0.2	48767
G	1	Carbon Stl	Carbon Stl	135	2-7/16x1-11/16	1-9/32	2	-	5/32	-	0.3	48768
H	1	Carbon Stl	Carbon Stl	135	2-7/16 Dia	1-1/2	2-3/16	-	5/32	-	0.4	48771
H	1-1/8	Carbon Stl	Carbon Stl	180	2-7/16 dia	1-19/32	2-3/16	-	5/32	-	0.4	48769
H	1-1/4	Carbon Stl	Carbon Stl	225	2-7/16 Dia	1-3/4	2-3/16	-	5/32	-	0.6	48770
I	11/16	Carbon Stl	Carbon Stl	90	15/16x1-7/32	3/4	31/32	11/16	1/8	11/16 Dia	0.2	48764
I	1	Carbon Stl	Carbon Stl	135	1-3/8x1-3/4	1-1/16	1-3/8	1	5/32	31/32 Dia	0.3	48766
I	1-1/8	Carbon Stl	Carbon Stl	180	1-3/8x1-3/4	1-3/16	1-3/8	1	5/32	31/32 Dia	0.4	48765
J	11/16	Carbon Stl	Carbon Stl	90	1-5/16 Dia	3/4	1-1/8 Dia	-	1/8	11/16	0.2	48760
J	1	Carbon Stl	Carbon Stl	135	1-23/32 Dia	1-1/16	1-15/32 Dia	-	5/32	31/32 Dia	0.3	48763
J	1-1/8	Carbon Stl	Carbon Stl	180	1-13/16 Dia	1-3/16	1-9/16 Dia	-	5/32	31/32 Dia	0.4	48761
J	1-1/4	Carbon Stl	Carbon Stl	225	2 Dia	1-5/16	1-11/16 Dia	-	5/32	1-1/16 Dia	0.5	48762
K	1-1/2	Nylon	Carbon Stl	125	3x3	1-13/16	2-19/32	2-7/16	-	-	1.0	37821
K	1-1/2	Nylon	Stainless Stl	125	3x3	1-13/16	2-19/32	2-7/16	-	-	1.0	37823
K	1-1/2	Carbon Stl	Carbon Stl	250	3x3	1-13/16	2-19/32	2-7/16	-	-	1.4	25912
K	1-1/2	Stainless Stl	Carbon Stl	250	3x3	1-13/16	2-19/32	2-7/16	-	-	1.4	37822
K	1-1/2	Stainless Stl	Stainless Stl	250	3x3	1-13/16	2-19/32	2-7/16	-	-	1.4	25913
L	1-1/2	Carbon Stl	Carbon Stl	250	3x3	2-1/32	2-19/32	2-7/16	-	-	1.5	37824
L	1-1/2	Stainless Stl	Stainless Stl	250	3x3	2-1/32	2-19/32	2-7/16	-	-	1.5	37825

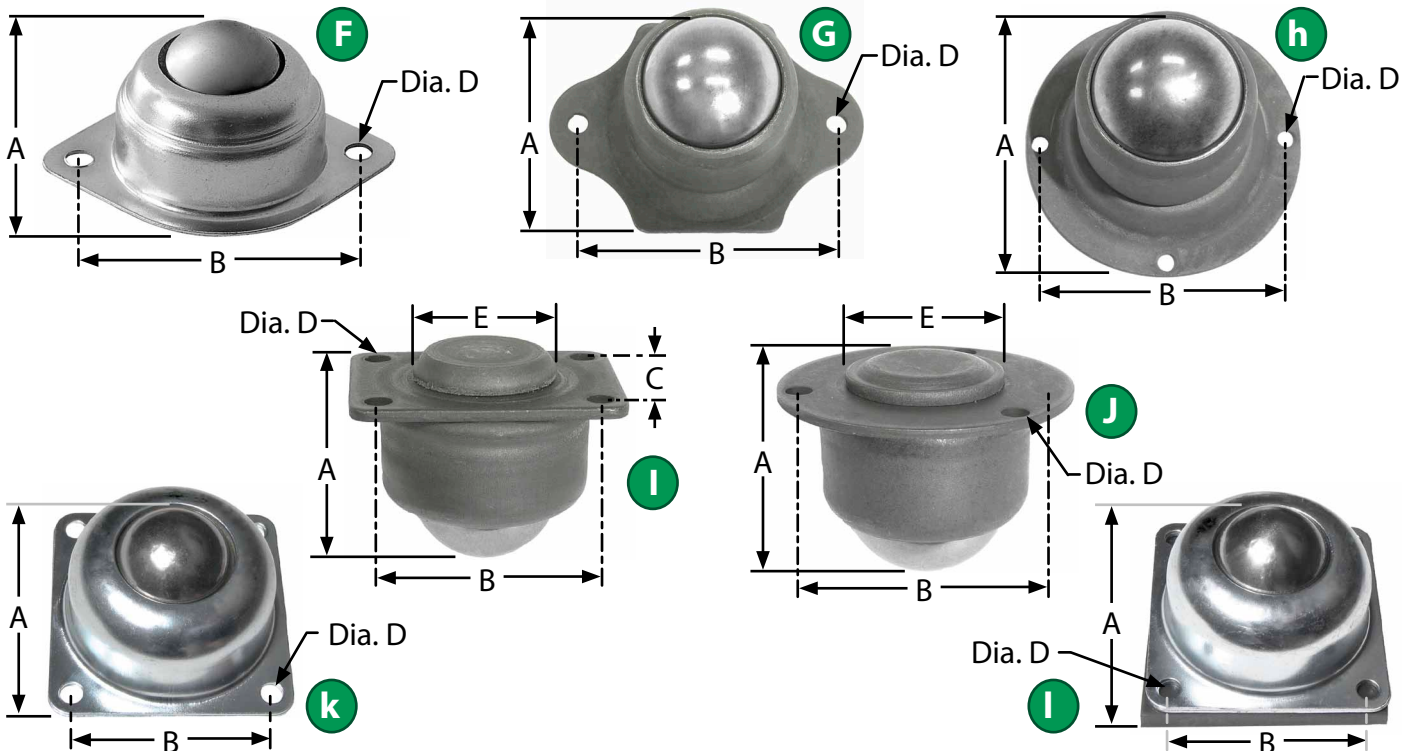

Ball Transfer

Ball Transfer

Ball Transfer units

Countersunk Flange Style Ball Transfer units

Key	Ball Dia. (In.)	Ball Material	Housing Material	Cap. (Lbs.)	Size (In.)	Mounting	A (In.)	B (In.)	C (In.)	D (In.)	E (In.)	Ship Wt.	Part No.
M	5/8	Carbon Stl	Carbon Stl	20	1-11/16 Dia	9/64 dia	3/8	1-11/16	1-1/4	9/64	3/8	0.3	37830
M	1	Carbon Stl	Carbon Stl	75	2-1/4 Dia	3/16 dia	5/8	1-7/32	1-3/4	3/16	19/32	0.5	37831
M	1	Stainless Stl	Carbon Stl	75	2-1/4 Dia	3/16 dia	5/8	1-7/32	1-3/4	3/16	19/32	0.5	37832
N	1	Nylon	Carbon Stl	35	2-3/4X2-1/8	7/32 dia	3/4	2-3/4	2-3/16	3/4	31/64	0.4	37827
N	1	CarbonStl	Carbon Stl	75	2-3/4X2-1/8	7/32 dia	3/4	2-3/4	2-3/16	3/4	31/64	0.6	37826
N	1	Stainless Stl	Stainless Stl	75	2-3/4X2-1/8	7/32 dia	3/4	2-3/4	2-3/16	3/4	31/64	0.6	37829

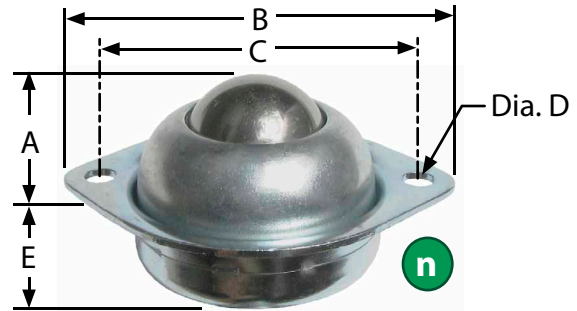
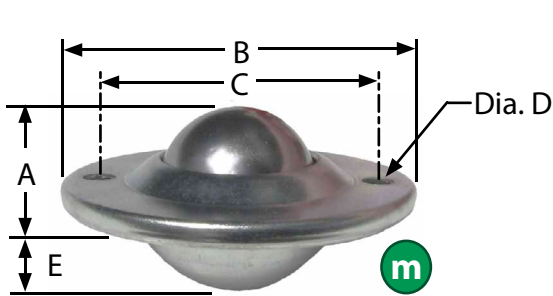

Drop-In & pipe Style Ball Transfer units

Key	Ball Dia. (In.)	Ball Material	Housing Material	Cap. (Lbs.)	A (In.)	B (In.)	C (In.)	D (In.)	Ship Wt.	Part No.
O	5/8	Carbon Stl	Carbon Stl	33	13/16	15/16	3/8	1-3/16	0.3	25910
O	1	Carbon Stl	Carbon Stl	200	1-1/4	1-3/8	5/8	1-43/64	0.6	25911
P	1-3/16	Carbon Stl	Carbon Stl	500	1-7/16	1-3/4	17/32	2	0.9	25909
P	1-3/16	Stainless Stl	Carbon Stl	500	1-7/16	1-3/4	17/32	2	0.9	23647
Q	1-1/2	Nylon	Carbon Stl	125	3-13/16	3	1-13/32	2-19/32	1.7	39045
Q	1-1/2	CarbonStl	Carbon Stl	250	3-13/16	3	1-13/32	2-19/32	1.7	39046
Q	1-1/2	Stainless Stl	Carbon Stl	250	3-13/16	3	1-13/32	2-19/32	2.3	39047

